

KEY:	
	EXISTING HIGHWAY BOUNDARY
	EXISTING CAMDEN / WESTMINSTER BOUNDARY
	PROPOSED HIGHWAY BOUNDARY
	EXISTING IRONWORK / UTILITY COVER TO BE ADJUSTED TO SUIT NEW LEVELS
	PROPOSED TREE <i>(for a typical construction section please refer to the City of Westminster standard detail No. SD-11-53 - Resin Bound Aggregate Tree Pit)</i>
	EXISTING STREET LAMP POST
	EXISTING BELISHA BEACON / "KEEP LEFT" BOLLARD
	EXISTING LEGIBLE LONDON INFORMATION SIGN
	RENEWED SHEFFIELD CYCLE STAND <i>(for installation details please refer to the City of Westminster standard detail No. SD-03-01 - Cycle Rack & Sign Detail)</i>
	RENEWED ROAD SIGN AND POST <i>(please refer to the following City of Westminster standard details for further information: SD-12-01 - Road Sign & Post Typical Layout, SD-12-04 - Traffic Sign Foundation)</i>
	RENEWED ROAD SIGN ON EX. LAMP POST
KERBS:	
	NEW 300mm(W) x 200mm(H) FULL HEIGHT GRANITE KERBS
	NEW 300mm(W) x 200mm(H) TRANSITION GRANITE KERBS
	NEW 300mm(W) x 200mm(H) GRANITE KERBS, LAID FLUSH
	NEW 150mm(W) x 200mm(H) FULL HEIGHT GRANITE KERBS
NOTE: 400mm WIDE STRIP OF CARRIAGEWAY IN FRONT OF THE NEW KERBS TO BE REMOVED TO ALLOW FOR INSTALLATION OF KERB BEDDING + HAUNCHING AND REINSTATED	
PAVEMENT CONSTRUCTION:	
	AREAS OF CARRIAGEWAY TO BE REGULATED / OVERLAID TO SUIT NEW LEVELS
	AREAS OF CARRIAGEWAY TO BE RESURFACED / REINSTATED FOLLOWING NEW KERB INSTALLATION
	AREAS OF FOOTWAY WORKS, DESIGN STANDARD 3 (PEDESTRIAN LOADS ONLY): <ul style="list-style-type: none"> 750mm X 600mm X 65mm CONCRETE PAVING SLABS 50mm SAND / CEMENT (3:1) BASE 100mm C16/20 WET LEAN CONCRETE, or 150mm TYPE 1
	AREAS OF FOOTWAY WORKS, DESIGN STANDARD 2 (OCCASIONAL VEHICLE LOADS): <ul style="list-style-type: none"> 750mm X 600mm X 62mm FIBRE REINFORCED CONCRETE PAVING SLABS 50mm SAND / CEMENT (3:1) BED 150mm C16/20 WET LEAN CONCRETE BASE, or 250mm TYPE 1, or 100mm TYPE 1 + 100mm CONCRETE
	PROPOSED BLISTER TACTILE PAVING, COLOUR GREY

ROAD MARKINGS SCHEDULE:	
	SINGLE YELLOW LINE TO TSRGD DIAG.1017: COLOUR: PRIMROSE YELLOW WIDTH: 100mm TSRGD 2016 REF: SCHEDULE 7, PART 4, ITEM 2
	DOUBLE YELLOW LINES TO TSRGD DIAG.1018.1: COLOUR: PRIMROSE YELLOW WIDTH: 100mm OFFSET: 100mm TSRGD 2016 REF: SCHEDULE 7, PART 4, ITEM 1
	EDGE OF CARRIAGEWAY MARKING TO TSRGD DIAG.1010: COLOUR: WHITE WIDTH: 150mm MARK: 1000mm GAP: 1000mm TSRGD 2016 REF: SCHEDULE 11, PART 4, ITEM 10
	PARKING BAY MARKINGS TO TSRGD DIAG.1028.4: COLOUR: WHITE WIDTH: 50mm MARK: 600mm GAP: 600mm TSRGD 2016 REF: SCHEDULE 7, PART 4, ITEM 6
	SOLID WHITE LINE MARKING TO TSRGD DIAG.1049(B): COLOUR: WHITE WIDTH: 150mm TSRGD 2016 REF: SCHEDULE 9, PART 6, ITEM 7
	CYCLE GIVE WAY MARKINGS TO TSRGD DIAG.1003(B): COLOUR: WHITE WIDTH: 100mm OFFSET: 150mm MARK: 300mm GAP: 150mm TSRGD 2016 REF: SCHEDULE 9, PART 6, ITEM 9
	CYCLE LANE MARKING TO TSRGD DIAG.1057: COLOUR: WHITE WIDTH: 750mm LENGTH: 1215mm TSRGD 2016 REF: SCHEDULE 11, PART 4, ITEM 28
	CYCLE ROUTE MARKING TO TSRGD DIAG.1057.1: COLOUR: WHITE LENGTH: 705mm TSRGD 2016 REF: SCHEDULE 11, PART 4, ITEM 29
	CYCLE ROUTE DIRECTION ARROW TO TSRGD DIAG.1059: COLOUR: WHITE WIDTH: 100/150mm LENGTH: 1000mm TSRGD 2016 REF: SCHEDULE 11, PART 4, ITEM 32

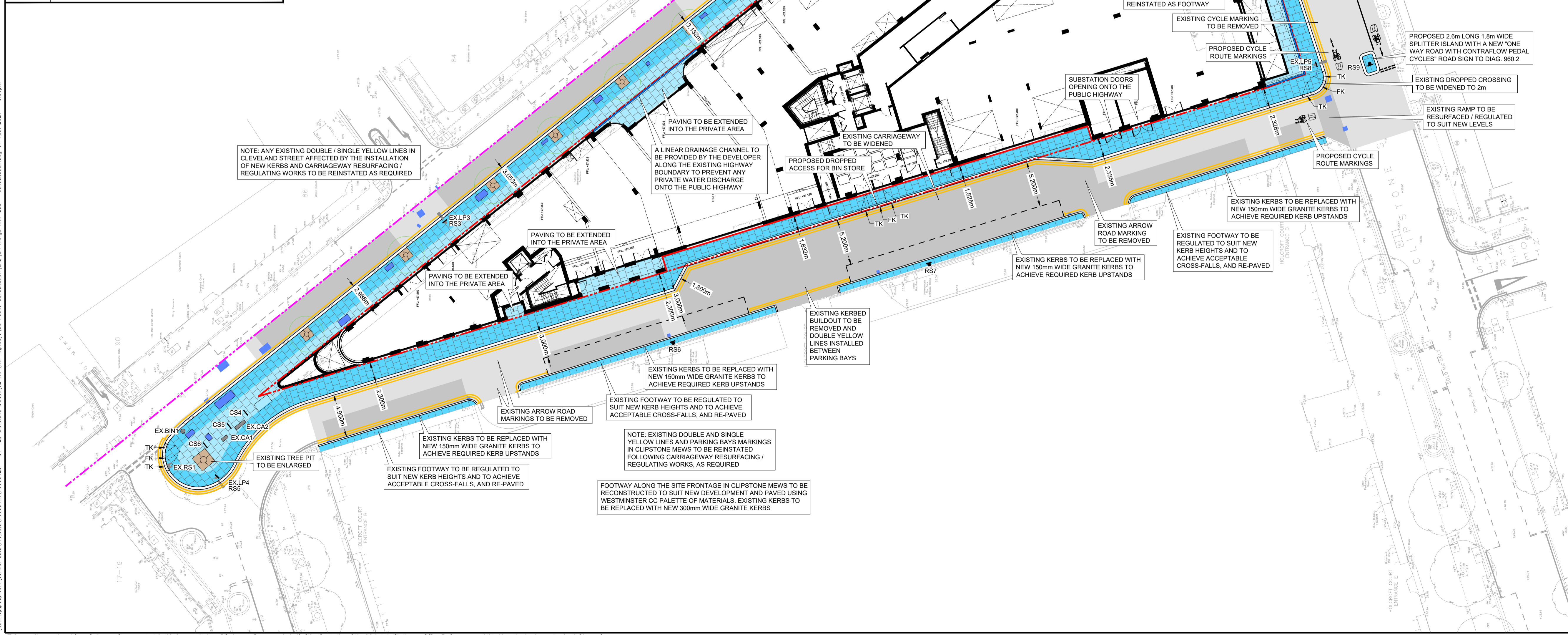
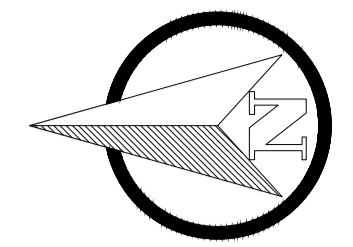

NOTES:

GENERAL

- Do not scale from this drawing.
- This drawing to be read in conjunction with other contract drawings.
- This drawing to be read & printed in colour.

CONSTRUCTION

- Works shall comply with the current Department of Transport Specification for Highway Works.
- Contractor is to allow for the removal of all existing road markings affected by the works.
- All new road markings to be in accordance with the "Traffic Signs Regulations and General Directions 2016" and the "Traffic Signs Manual, Chapter 5".
- All new road markings to be hot applied thermo plastic.
- All tactile and other hazard warning paving to be installed in accordance with the "Guidance on the use of Tactile Paving Surfaces".
- All existing gully gratings and frames within the area of Highway works to be upgraded to the new Class D400 cycle friendly gully gratings and frames.

CDM (RISKS & HAZARDS)

- Prior to commencement of construction the contractor is to liaise with all relevant statutory undertakers and protect / divert apparatus and to protect the workforce during the works. Any damage caused to the apparatus to be the responsibility of the contractor.
- Contractor to undertake their own statutory plant checks on site prior to the commencement of excavation exercise.
- The contractor is to make sure that any excavation should be adequately covered at night to protect both public and wildlife from becoming trapped (please refer to the City of Westminster standard detail No. SD-05-26 - Cycle Friendly Gully).

DISCLAIMERS

- The topographical survey information has been provided by MSA Survey (drawing No. 4188-T), and TTP shall not be liable for any inaccuracies or deficiencies.
- The internal layout has been provided by Assael Architecture Limited (drawing No. A2494 SK19.03 05_01 (PFS Ground Floor)).

SCHEDULE OF STREET FURNITURE:	
REF	DESCRIPTION
CS1-CS6	6No RENEWED SHEFFIELD CYCLE STANDS
EX.LL	EXISTING LEGIBLE LONDON SIGN
EX.KLB	EXISTING KEEP LEFT BOLLARD
EX.BB1, EX.BB2	2No EXISTING BELISHA BEACONS
EX.LP1 - EX.LP6	6No EXISTING STREET LAMP POSTS
EX.CA1 - EX.CA2	2No EXISTING CABINETS
EX.RS1	EXISTING BACK-TO-BACK "NO ENTRY" AND "NO LEFT TURN" ROAD SIGNS.
RS1	RENEWED "TRAFFIC MUST PROCEED TO THE LEFT" ROAD SIGN, FIXED ON EXISTING LAMP POST.
RS2	RENEWED BACK-TO-BACK "NO ENTRY" / "TRAFFIC MUST PROCEED TO THE RIGHT" AND "GIVE WAY" / "TRAFFIC MUST PROCEED TO THE LEFT" ROAD SIGNS WITH A NEW LIGHTING UNIT, ON A NEW POST.
RS3	RENEWED "TRAFFIC MUST PROCEED TO THE LEFT", "ONE WAY" AND "CONTROLLED ZONE" SIGNS, FIXED ON EXISTING LAMP POST.
RS5	RENEWED "SCHOOL" SIGN ON YELLOW BACKBOARD, FIXED ON EXISTING LAMP POST.
RS6	RENEWED "RESIDENT PERMIT HOLDERS ONLY" ROAD SIGN ON A NEW POST.
RS7	RENEWED "RESIDENT PERMIT HOLDERS ONLY" ROAD SIGN ON A NEW POST.
RS8	RENEWED "MOTOR VEHICLES PROHIBITED", "EXCEPT FOR ACCESS" AND "ONE WAY TRAFFIC" ROAD SIGNS AND A NEW LIGHTING UNIT, FIXED ON EXISTING LAMP POST.

REV	DATE	BY	DESCRIPTION	CHK	APD
P01	01.02.2021	JLJN	INITIAL ISSUE		

DRAWING STATUS

CONSULTATION

25 Mandala Way, London, SE1 5SZ
www.fmconway.co.uk www.wsp.com

CITY OF WESTMINSTER

City of Westminster

PROJECT

**87 -125 CLEVELAND STREET
S278 PUBLIC REALM IMPROVEMENT SCHEME**

TITLE

GENERAL ARRANGEMENT

SCALE	DATE	DESIGN/DRAWN	CHECKED	APPROVED	SHEET
SCALE @ A1	01.02.2021	JLJN	DV	DD	A1
JOB No:	FMC PROJECT No:	DESIGN No:	REF/ISS No:		
70055423	WWESA2502		C.WD11704		
DRAWING No:					
70055423-WSP-P01-X-DR-HI-0100-01					P01

This map is reproduced from Ordnance Survey material with the permission of Ordnance Survey on behalf of the Controller of Her Majesty's Stationery Office © Crown copyright. Unauthorised reproduction infringes Crown copyright and may lead to prosecution or civil proceedings. (WCC/LA 100013597)